

# INSTALLATION AND SERVICE MANUAL

**LIGMAN**  
LIGHTING USA

For Installation of Tango cylindrical square wall down light LED.  
Model. UTA-31791 , UTA-31811

## Product drawing (dimensions)

SUITABLE FOR WET LOCATIONS

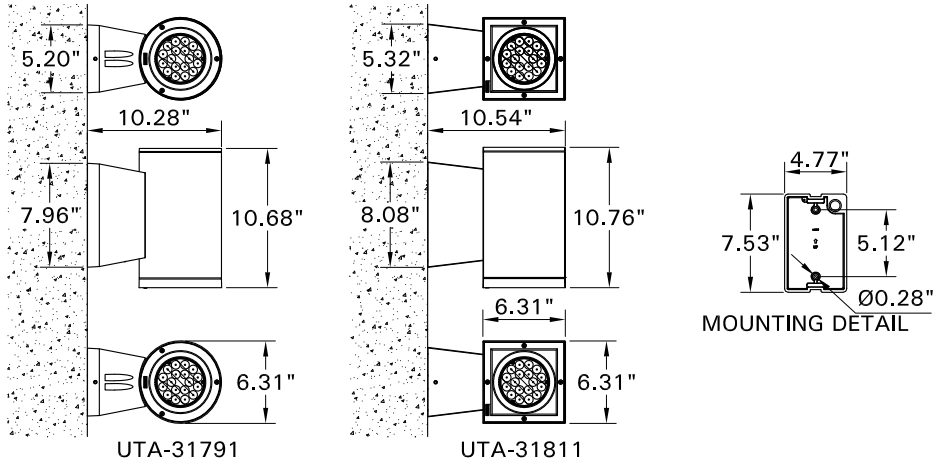

**NOTE**  
Mounts over  
Junction box.

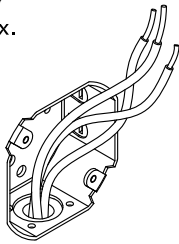

①

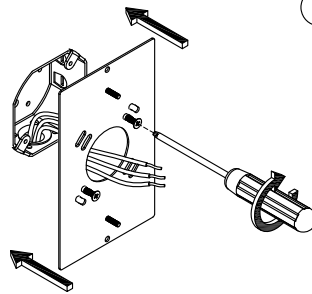

②

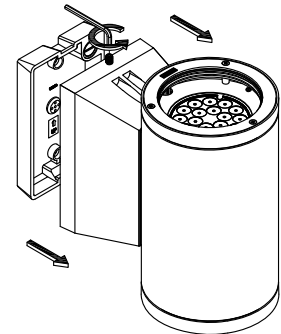

③

Using the nylon washers  
and the 7mm. nut driver  
secure the back  
plate to the wall

UP

④

Ensure watertight seal using UL  
approved silicone based sealant.

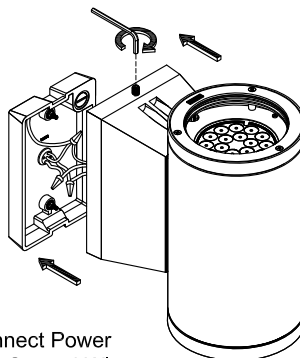

⑤

Connect Power  
and Ground Wire.

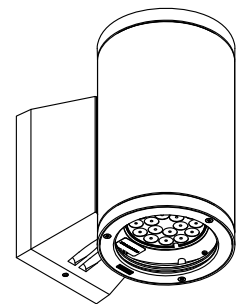

⑥

## Notice to installer :

- 1.WIRING INSTRUCTIONS Warning :** RISK OF FIRE AND ELECTRICAL SHOCK. : FIXTURE MUST BE INSTALLED BY A QUALIFIED ELECTRICIAN ONLY>FIXTURE IS INTENDED FOR INSTALLATION IN ACCORDANCE WITH THE NATIONAL ELECTRICAL CODE, LOCAL AND FEDERAL CODE SPECIFICATIONS. DISCONNECT POWER BEFORE SERVICING.
- 2.This fixture has a VOLTAGE SPECIFIC BALLAST,**Check that the supply voltage is the same as the installed ballast voltage.

**Ligman Lighting USA**

7144 NE Progress Court, Hillsboro  
Oregon, 97124, USA  
Tel : 503 645 0500 | Fax : 503 645 8100

www.ligmanlightingusa.com

UTA-31791 29/03/24 REV\_2  
1/1

FM-TS-13-1/13-05-2563/Rev.6